

SPINNAKER DRIVE

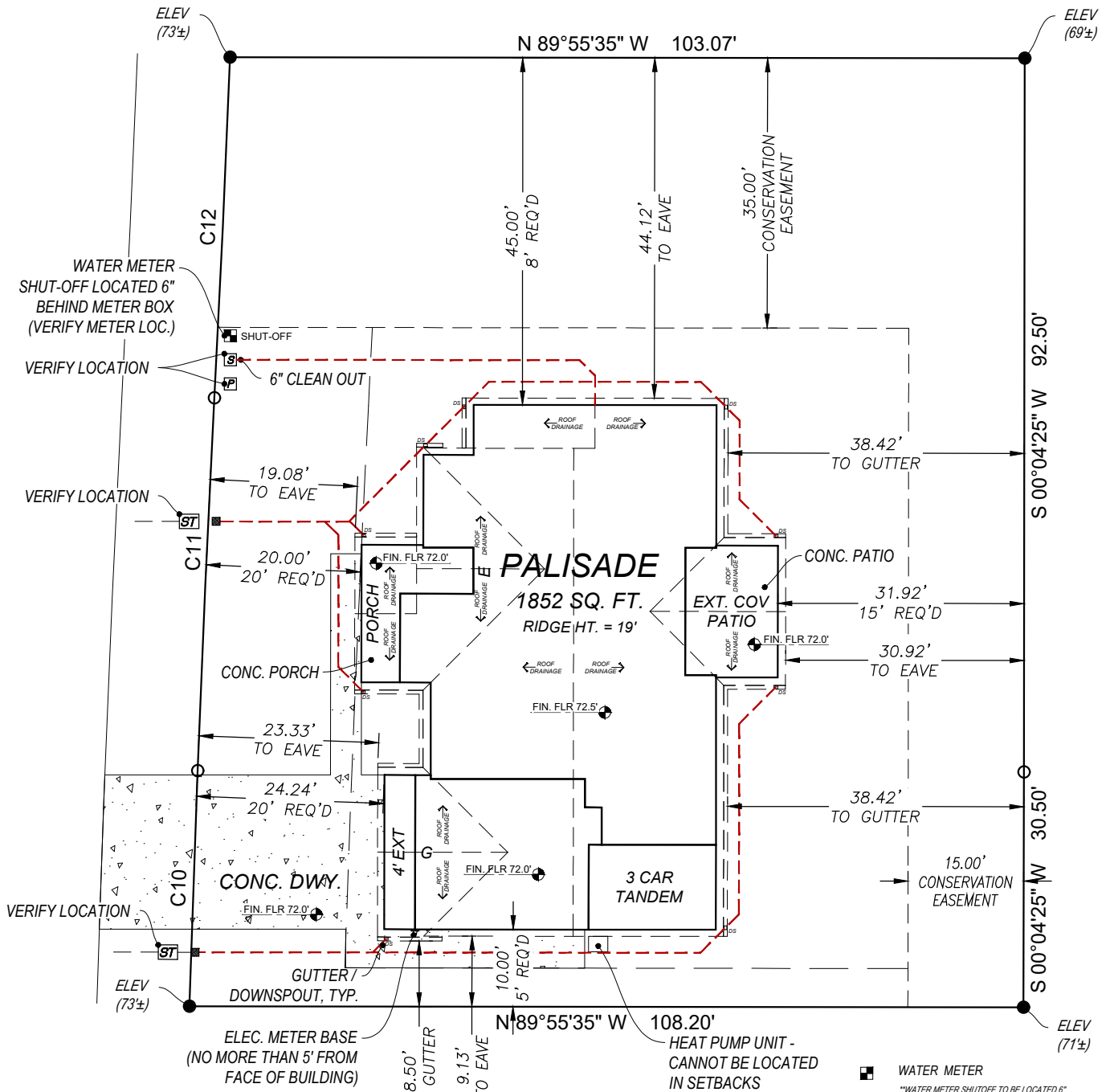

CURVE TABLE

CURVE	DELTA	RADIUS	LENGTH	CHORD BRG.	CHORD
C10	00°26'26"	3970.00'	30.52'	N 02°01'11" E	30.52'
C11	00°41'55"	3970.00'	48.41'	N 02°35'21" E	48.41'
C12	00°37'41"	4030.00'	44.18'	N 02°37'28" E	44.18'

LOT AREA (SF)	BUILDING AREA (SF)	BUILDING COVERAGE (50% MAX.)	IMPERVIOUS AREA (SF)	IMPERVIOUS COVERAGE (65% MAX)
13,009	2,909	22.4%	3,922	30.1%

ROOF OVERHANGS - 12" + 4" GUTTERS = 16" TOTAL

EAVES CANNOT ENROACH SETBACKS MORE THAN 18"

ALL DRAINAGE FROM GUTTERS WILL BE ROUTED TO CATCH BASIN

NO STEPS FROM PORCH TO HOUSE OR PORCH TO GRADE

PORCH OUTLINE IS CONCRETE BELOW AND IS WIDER THAN HOME DUE TO PORCH COLUMNS. SEE FLOOR PLAN FOR REFERENCE

- WATER METER  
\*\*WATER METER SHUTOFF TO BE LOCATED 6" BEHIND METER BOX
- Ⓜ POWER METER BASE
- Ⓢ SEWER
- ⓈⓈ STORM WATER  
\*\*ALL DRAINAGE FROM GUTTERS TO ENTER DETENTION AREA
- DOWNSPOUT

MAP & TAX LOT #: 28S-15W36CD-00614  
ACCOUNT #: R7776900  
LOT AREA: 9,724 S.F. (0.22 ACRES)

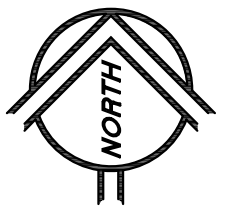

SCALE 1:20



# THE HATTRUP RESIDENCE

SPINNAKER DRIVE,  
BANDON, OR