



**EROSION CONTROL NOTES:**

1. IT IS THE RESPONSIBILITY OF THE CONTRACTOR TO PROVIDE A QUALIFIED EROSION CONTROL INSPECTOR. CONTRACTOR TO PROVIDE THE EROSION CONTROL INSPECTOR'S NAME AND QUALIFICATIONS TO THE ENGINEER PRIOR TO BEGINNING CONSTRUCTION.
2. INSTALL SEDIMENT FENCE AND PERIMETER EROSION CONTROL MEASURES PRIOR TO BEGINNING CONSTRUCTION.
3. LEAVE NATIVE VEGETATION UNDISTURBED OUTSIDE AREAS OF CONSTRUCTION.
4. MODIFY EROSION CONTROL METHODS AS REQUIRED DUE TO WEATHER OR CONSTRUCTION CHANGES.
5. SEE EROSION CONTROL DETAIL SHEETS FOR ADDITIONAL NOTES AND DETAILS.
6. LOCATION OF ESCP FACILITIES SHOWN ARE APPROXIMATE. ALL FACILITIES TO BE FIELD PLACED PER CONSTRUCTION REQUIREMENTS.
7. CONTRACTOR TO MECHANICALLY REMOVE SEDIMENT FROM ROAD AND SHALL NOT WASH IT DOWN STORM SEWERS.

**NOTES:**

1. REFERENCE "GENERAL NOTES" ON SHEET C6.1
2. REFERENCE "ABBREVIATIONS" ON SHEET C6.1
3. REFERENCE "LEGEND" ON SHEET C6.1

**CONSTRUCTION NOTES:**

1. ALL SLOPES GREATER THAN 3:1 SHALL BE TREATED WITH 0.5' DEEP 6"-8" ROCK RIPRAP
2. ACCESSIBLE PARKING AND UNLOADING SPACES SHALL HAVE A MAXIMUM 2% SLOPE/CROSS SLOPE
3. CONSTRUCT LANDSCAPE DETENTION BASIN AS PER DETAIL 6, SHEET C6.4

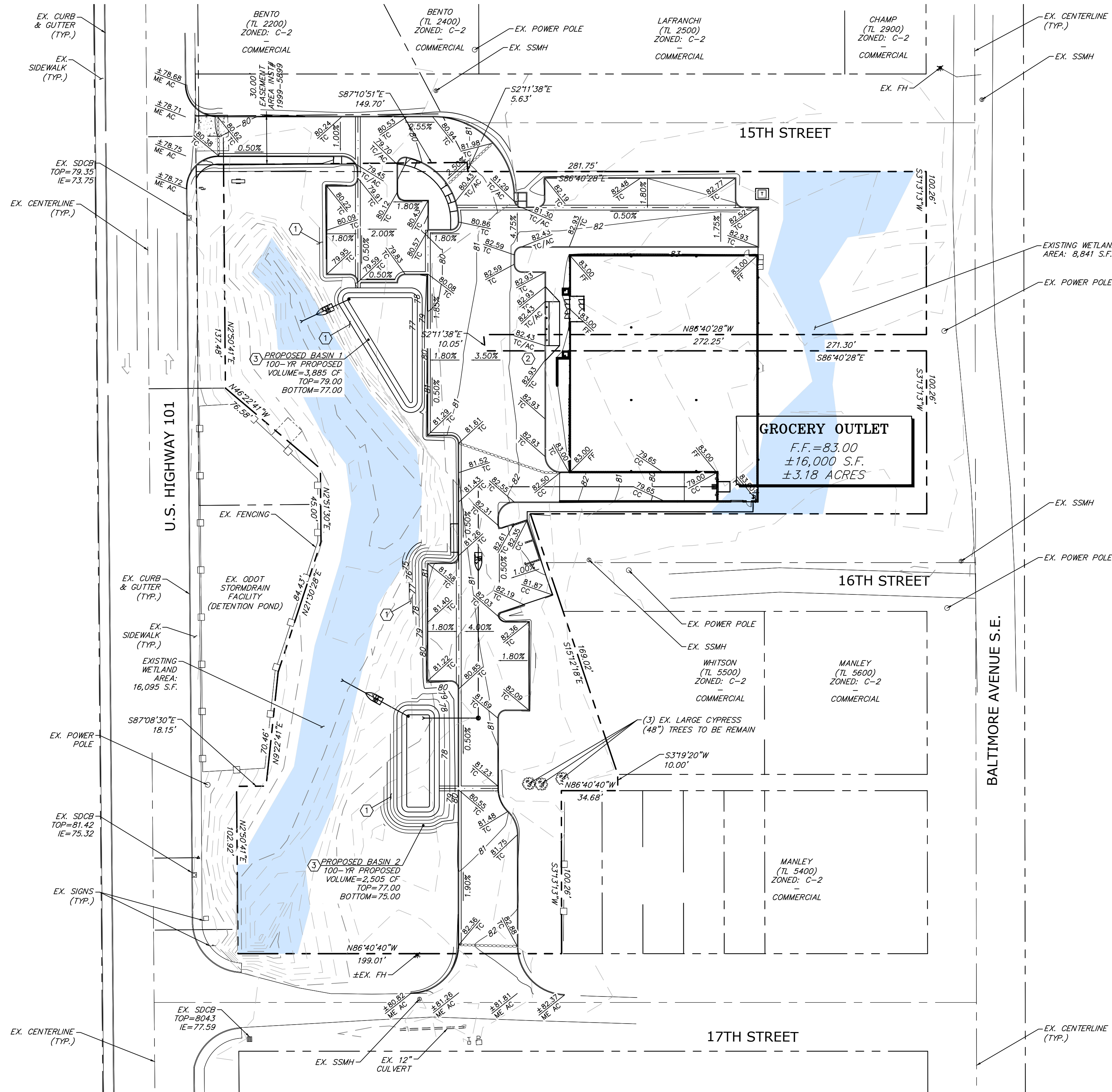

**GRADING PLAN**

SCALE: 1" = 40'-0"

